

Thank you for ordering an upgrade to **auto-matePRO**.

Here are your instructions. All that we require is for you to send us the control unit and a form.

INSTRUCTIONS

- Complete the lodgement form overleaf and return it with your unit.
- Unplug the control unit and remove it.
- Locate the link plug originally supplied with your unit (the Pajero has two link plugs). Plug it into the cable. The link plug/s return the transmission to factory operation. In the Pajero, without them you will get a transmission error (flashing N) that disables Sport mode and cruise control. It is OK to drive without the link plug/s, you will just have the error which will need to be cleared once the control unit is installed again.
- At your local Post Office purchase a padded mailer that your control unit will fit into. *Note: The Parcel Collect service is only provided by Australia Post. If you wish to use an alternative courier, please let us know as a different address is needed.*
 - Address to: MM4X4
Parcel Collect 10156 19100
1242 North East Road
ST AGNES SA 5097
- Write your sender details on the rear of the mailer.
- At the counter, you will be required to sign a Dangerous Goods Declaration. **We highly recommend purchasing insurance** for your package as we can't take responsibility if it doesn't arrive.
- Keep a record of your tracking number.
- As soon as your control unit has been dispatched, please send us an email to let us know: enquiries@mm4x4.com.au.
- We will send you a return email when your control unit is received by us.
- Download your **auto-matePRO Operation Manual** via our website at <https://www.mm4x4.com.au/operation-booklets-for-our-products>

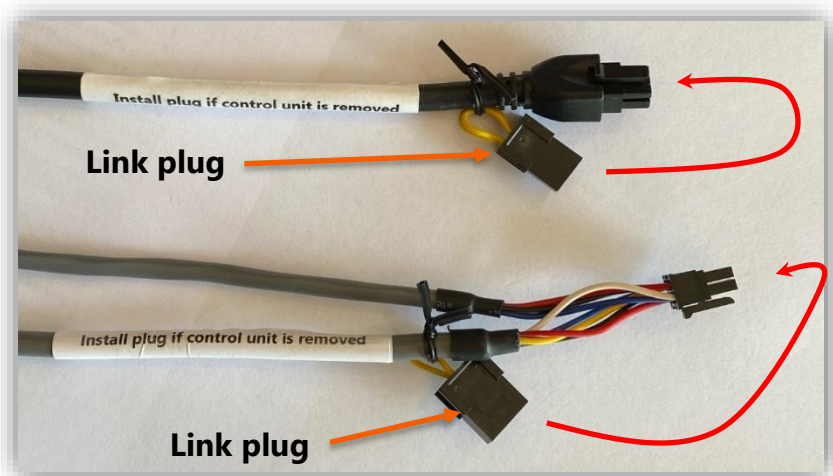

MM4X4 UPGRADE TO auto-matePRO LODGEMENT FORM

PLEASE SEND THIS COMPLETED FORM TO MM4X4 WITH YOUR UNIT

Name:

TITLE	FIRST NAME	SURNAME
-------	------------	---------

Return Address:

STREET	_____

SUBURB	_____
STATE	_____
	POSTCODE _____

Thank you